

LOCTITE® VALVE ASSEMBLY REPLACEMENT #97999

Removing Valve Assembly

- Hold valve assembly in hand.
- While holding valve in hand, rotate ring clockwise until valve assembly is disengaged from actuator assembly.
- Next, pull valve assembly, including product feedline, out through the actuator assembly.

Installing New Valve Assembly #97999

- First, insert the product feedline through the hole in the actuator assembly and pull through.
- While holding valve in hand, engage the valve into the ring, rotate ring counterclockwise until hand tightened.
- Prime the hand-held applicator as shown in section 5.1.1 of the applicator's instruction manual.

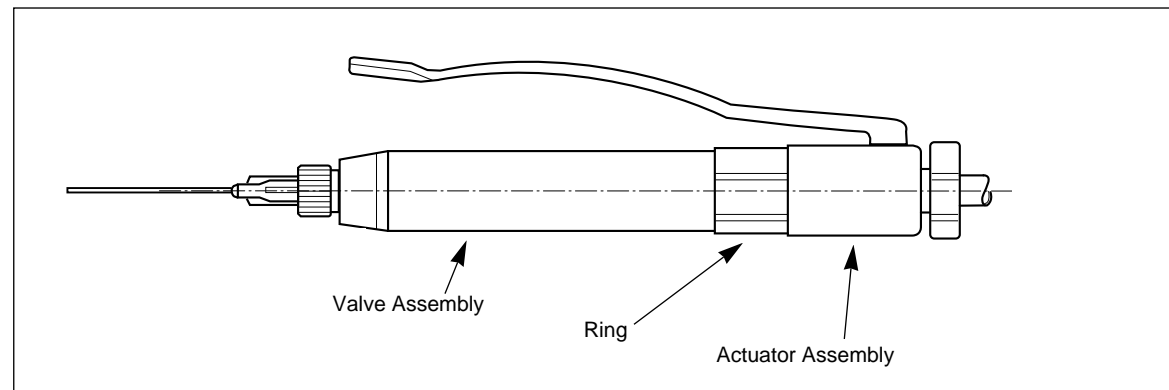

 **Loctite Corporation**
Loctite (Ireland) Ltd.
Tallaght Business Park
Whitestown
Tallaght, Dublin 24, Ireland
North American Group
1001 Trout Brook Crossing
Rocky Hill, CT USA 06067